

DocuPrint C3055

Duplex Unit Installation Guide

Thank you for purchasing the duplex unit.

This guide is intended for first-time users of the printer and gives instructions on installing this product to the printer.

To ensure safe operation of the printer, be sure to read "Safety Notes" in the Quick Reference Guide before starting the installation.

⚠ WARNING

- Never open or remove machine covers that are secured with screws unless specifically instructed in the related manuals. A high voltage component can cause electric shocks.
 - Do not try to alter the machine configuration, or modify any parts. An unauthorized modification can cause smoke or fire.
-

⚠ CAUTION

- Switch off the machine before connecting the interface cable or optional accessories. Connecting the cable or optional accessories with a live machine can cause electric shocks.
-

Checking the Package Contents

The packaging box contains the following items. If you find any items missing, please contact our Customer Support Center or your dealers.

- Duplex unit
- This guide

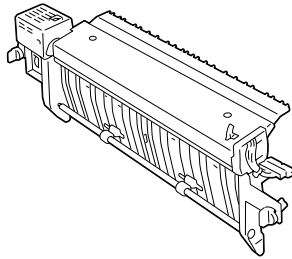

English

한국어

繁體中文

简体中文

Installation Procedure

1. Switch the power off by pressing the power switch located on the left side of the printer to the <O> position. Unplug the power cord from the power outlet and the printer.

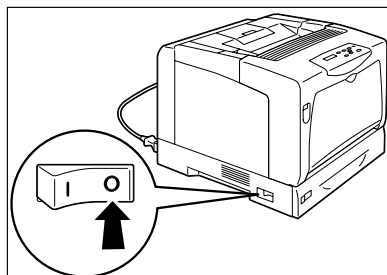

2. If paper is loaded in the bypass tray, remove the paper and close the bypass tray cover.

Important

- When closing the bypass tray cover, be careful not to get your fingers caught between (the left or right edge of) the cover and the printer.

3. Press the button B and open the front cover.

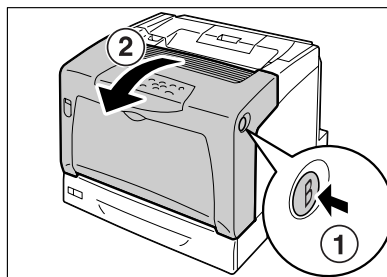

4. Insert the projections on both sides of the duplex unit into the slots labelled with arrows.

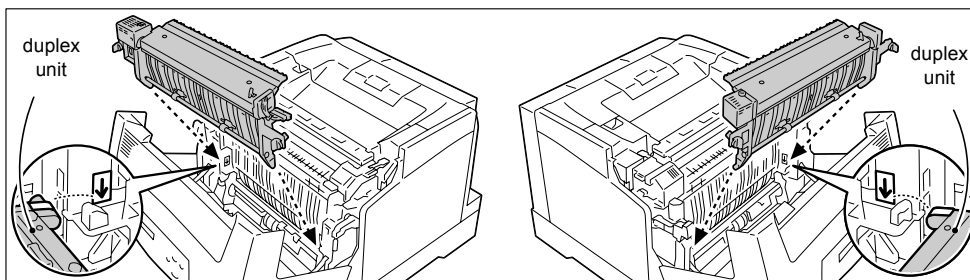

5. Tilt the duplex unit toward the back of the printer with the side inserted into the printer as an axis. Turn the gray knobs on both sides of the duplex unit to secure the unit to the printer. Turn the knobs until they are horizontal as in the figure.

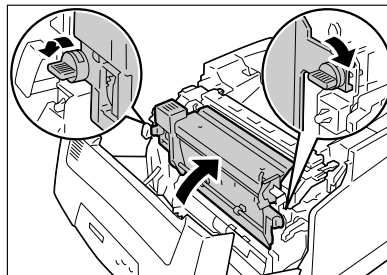

6. Remove the gray cover from the connector inside the printer.

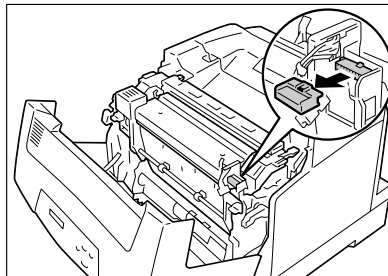

7. Plug the connector cable extended from the right side of the duplex unit to the connector in the printer.

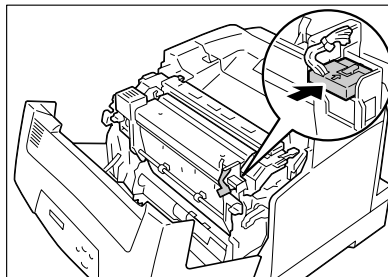

8. Close the front cover.

Important

- When closing the front cover, be careful not to get your fingers caught between (the left, right, top, or bottom edge of) the cover and the printer.

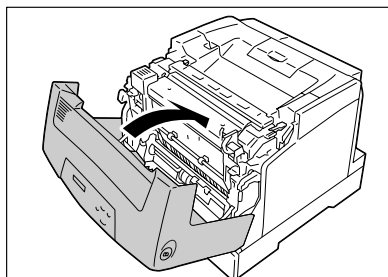

9. Plug in the power cord and switch the power on by pressing the power switch to the <|> position.

The installation is now complete.

Note

- You can check whether the duplex unit has been installed correctly by printing out the [Printer Settings] list. Refer to the Quick Reference Guide on how to print the [Printer Settings] list.
- After installing the duplex unit, change the accessory configuration on your print driver. For more information, refer to the online help provided for the print driver.

English

한국어

繁體中文

简体中文

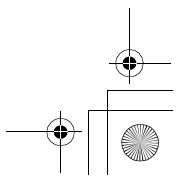
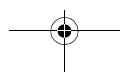
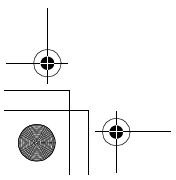
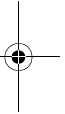
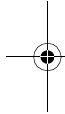
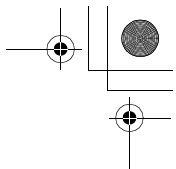
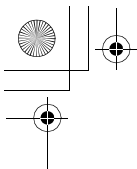

DocuPrint C3055

양면 유닛 설치 설명서

양면 유닛을 구입해 주셔서 감사드립니다 .

본 설명서는 프린터를 처음으로 구입한 사용자를 위해 본 제품을 프린터에 설치하는 방법에 대한 지침을 제공합니다 .

프린터의 안전한 작동을 위하여 , 설치하기 전에 핵심 가이드의 " 안전하게 사용하기 위하여 " 를 읽어 주십시오 .

⚠ 경고

- 나사로 고정되어 있는 패널이나 커버 등은 함께 제공된 설명서가 지시하는 곳 이외에는 절대로 열지 마십시오 . 내부에는 전압이 높은 부분이 있어 감전의 원인이 될 수 있습니다 .
- 기계를 개조하거나 부품을 변경하여 사용하지 마십시오 . 화재나 발연의 원인이 될 수 있습니다 .

⚠ 주의

- 인터페이스 케이블 및 옵션 액세서리를 접속할 때는 반드시 전원스위치를 꺼 주십시오 . 감전의 원인이 될 수 있습니다 .

패키지 내용물 확인

패키지에는 다음과 같은 항목이 포함되어 있습니다 . 항목이 누락된 경우 고객 지원 센터 또는 판매 대리점에 문의하여 주십시오 .

- 양면 유닛

- 본 설명서

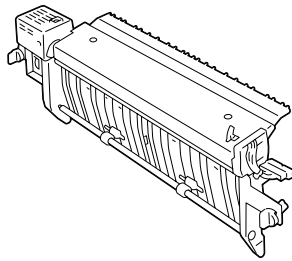

English

한국어

繁體中文

简体中文

설치 순서

1. 프린터 왼쪽에 있는 전원 스위치의 <O> 를 눌러 전원을 끕니다 .
프린터 및 전원 콘센트에서 전원 코드를 뽑습니다 .

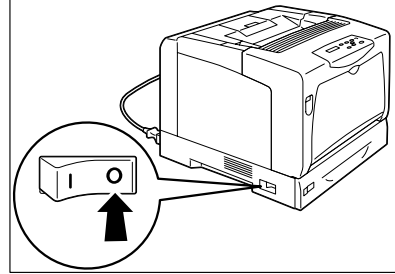

2. 수동 트레이에 용지가 있는 경우 용지를 제거하고 수동 트레이 커버를 닫습니다 .

중요

- 수동 트레이 커버를 닫을 때 손가락이 커버 (좌측 또는 우측 모서리) 및 프린터 사이에 끼이지 않도록 주의합니다 .

3. 버튼 B 를 누르고 앞커버를 엽니다 .

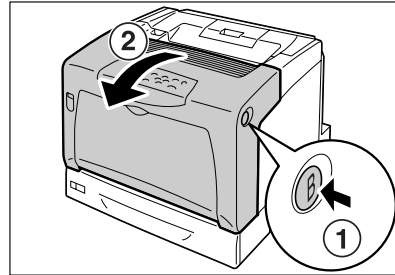

4. 양면 유닛의 양쪽에서 돌출부를 화살표가 표시된 슬롯에 삽입합니다 .

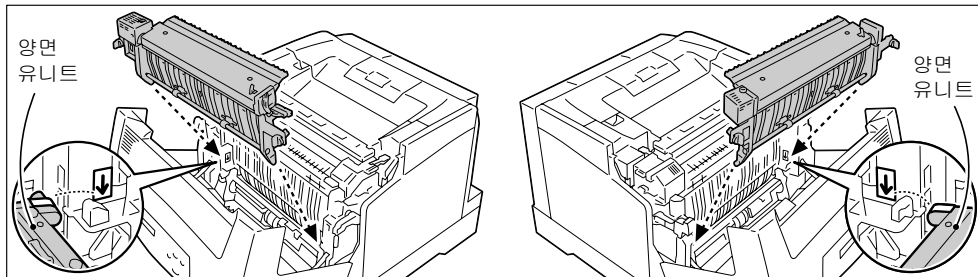

5. 양면 유닛 측면이 프린터에 축 방향으로 삽입된 상태에서 프린터 뒤쪽으로 양면 유닛을 기울입니다 . 양면 유닛의 양쪽에서 회색 손잡이를 돌려 장치를 프린터에 고정합니다 . 손잡이가 그림에 표시된 것과 같이 수평이 될 때까지 돌립니다 .

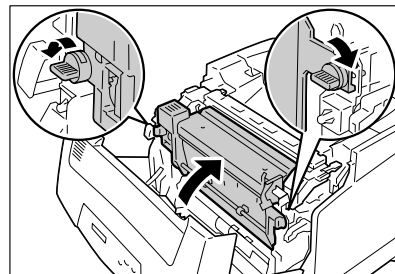

- 6. 프린터 안쪽 커넥터에서 회색 커버를 제거합니다 .

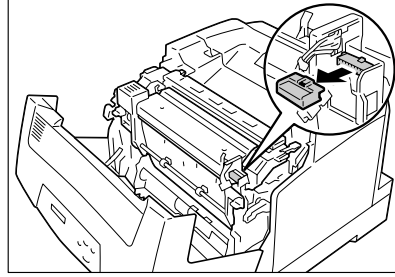

- 7. 양면 유닛의 오른쪽에서 연장된 커넥터 케이블을 프린터 커넥터에 연결합니다 .

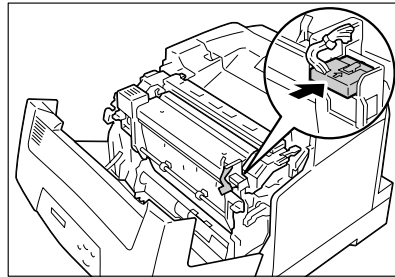

- 8. 앞커버를 닫습니다 .

중요

- 앞커버를 닫을 때 손가락이 커버 (좌측 또는 우측 모서리) 및 프린터 사이에 끼이지 않도록 주의합니다 .

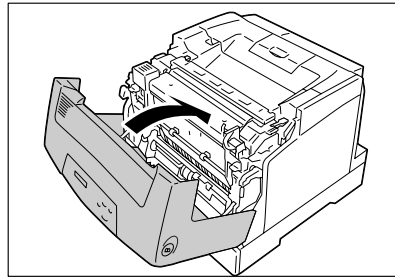

- 9. 전원 코드를 연결하고 전원 스위치의 <|> 위치를 눌러 전원을 켭니다 .

설치가 완료되었습니다 .

보충

- [Printer Settings] 리스트를 프린트하여 양면 유닛이 제대로 설치되었는지 여부를 확인할 수 있습니다 . [Printer Settings] 리스트 프린트 방법에 대한 자세한 내용은 핵심가이드를 참고하여 주십시오 .
- 양면 유닛을 설치한 후 프린터 드라이버에서 액세서리 구성을 변경합니다 . 자세한 내용은 프린터 드라이버의 온라인 도움말을 참고하여 주십시오 .

English

한국어

繁體中文

简体中文

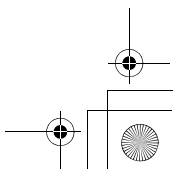
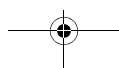
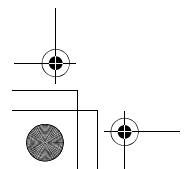
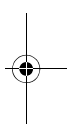
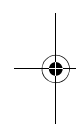
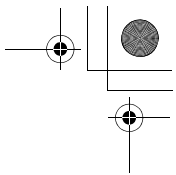

DocuPrint C3055

雙面組件安裝說明書

感謝您選用雙面組件。

本說明書適用於初次使用本印表機的使用者，並說明如何將本產品安裝至印表機。

為了確保印表機的安全操作，開始安裝程序之前，請務必先閱讀『快速參考說明書』中的“為了機器的安全使用”。

⚠ 警告

- 嚴禁開啓相關說明書未指示的、用螺絲固定住的控制板與蓋，以免接觸到內部的高壓部而引起觸電。
- 請勿擅自改造機器、更換零件，以免機器起火或冒煙。

⚠ 注意

- 連接介面電源線或加裝產品以前，請務必關閉機器的電源。在機器電源打開的狀態下連接電源線或加裝產品可能會引起觸電。

檢查包裝內容

包裝盒內含有下列項目。若您發現有項目短少，請聯絡本公司的客服支援中心或經銷商。

- 雙面組件

- 本說明書

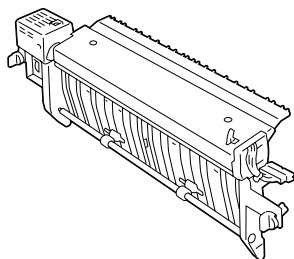

English

한국어

繁體中文

简体中文

安裝程序

1. 將印表機左側的電源開關切換到 <0> 的位置，關閉電源。
將電源線的插頭從電源插座與印表機拔除。

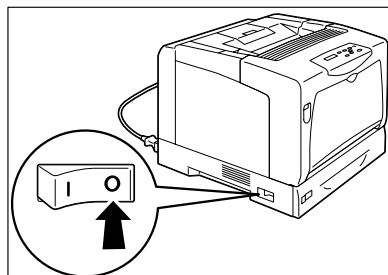

2. 若手送紙盤中裝有紙張，請取出紙張，關閉手送紙盤的外蓋。

重要

- 關閉手送紙盤的外蓋時請留意，避免手指夾在外蓋（左右邊緣）與印表機之間。

3. 按下 B 按鈕，開啓前蓋。

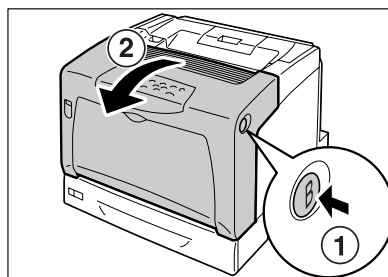

4. 將雙面組件兩邊的突出部分插入以箭頭標示的插槽中。

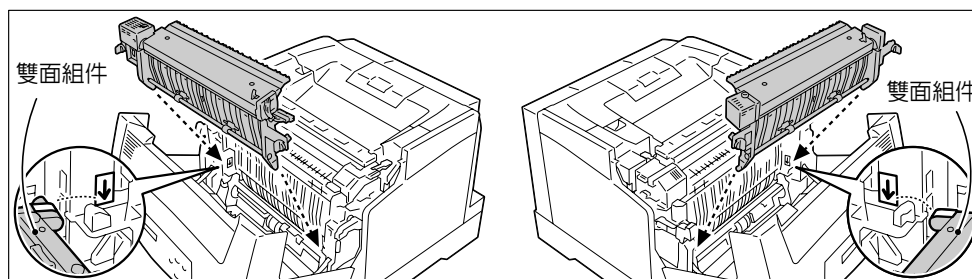

5. 以插入印表機那一側為軸，將雙面組件朝印表機的後面傾斜。轉動雙面組件兩側的灰色旋鈕，將組件固定在印表機上。轉動旋鈕直到如圖所示呈水平狀態為止。

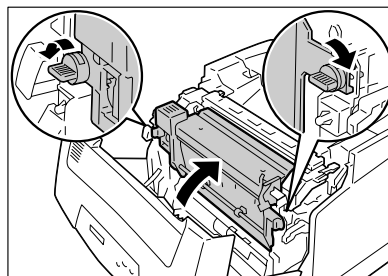

6. 將灰色蓋子從印表機內部的連接器取出。

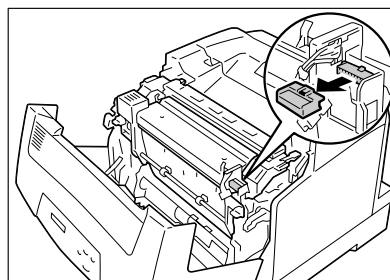

7. 將雙面組件右側的連接器纜線插到印表機內的連接器。

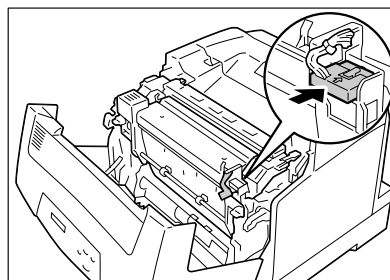

8. 關上前蓋。

重要

- 關閉前蓋時請留意，避免手指夾在外蓋（上下左右邊緣）與印表機之間。

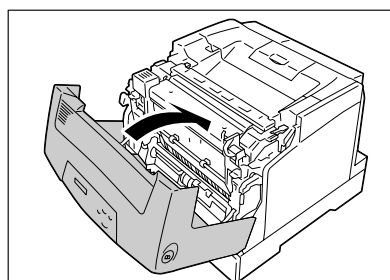

9. 插好電源插頭，將電源開關按到 <|> 位置，開啓電源。

安裝程序即完成。

補充

- 您可以列印 [Printer Settings] 清單，以檢查雙面組件是否正確安裝。有關如何列印 [Printer Settings] 清單的詳情，請參照『快速參考說明書』。
- 安裝雙面組件之後，請變更列印驅動程式上的配件配置。有關詳情，請參照列印驅動程式的線上說明。

English

한국어

繁體中文

简体中文

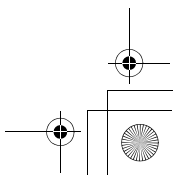
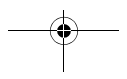
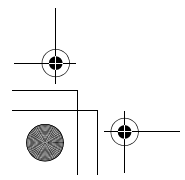
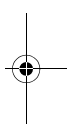
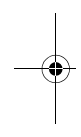
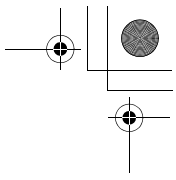
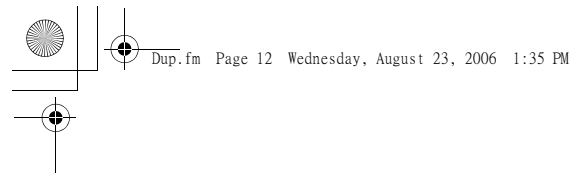

DocuPrint C3055

自动双面组件安装说明书

感谢您购买自动双面组件。

本说明书供初次使用本打印机的用户使用，其中介绍了将本产品安装到打印机上的方法。为保证打印机的安全操作，务必在开始安装前阅读《快速参考说明书》中的“安全注意事项”。

警告

- 严禁开启使用说明书未指示的用螺丝固定住的控制板与盖，以免接触到内部的高压部位而引起触电。
- 请勿擅自改造机器、更换零件，以免机器起火或冒烟。

注意

- 连接界面电缆及选装产品时，请务必关闭电源，以免引起触电。

检查包装盒内容

包装盒内应装有以下物品。如果发现有任何物品缺少，请联络本公司客户支持中心或经销商。

- 自动双面组件

- 本说明书

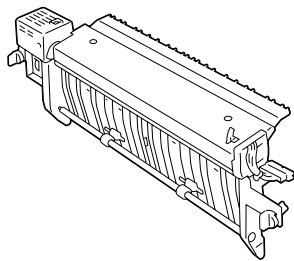

English

한국어

繁體中文

简体中文

安装步骤

1. 将位于打印机左侧的电源开关按到 <0> 位置，关闭电源开关。
从打印机及电源插座上拔出电源线。

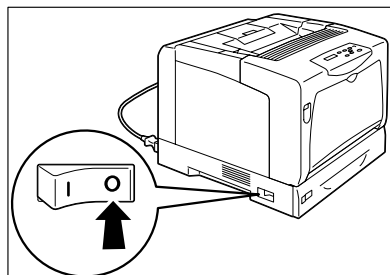

2. 如果旁路纸盘装有纸张，请取出纸张并关闭旁路纸盘盖板。

重要

- 在关闭旁路纸盘盖板时，当心您的手指不要夹在盖板（左侧或右侧边缘处）与打印机之间。

3. 按下按键 B 并打开前盖。

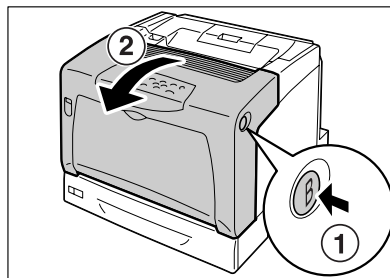

4. 将自动双面组件两侧的凸出部分插入标有箭头的插槽中。

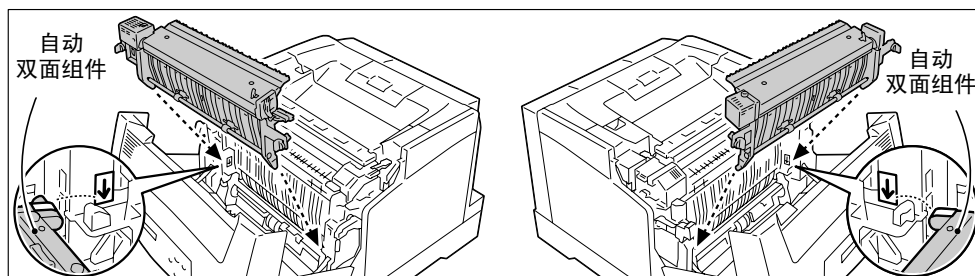

5. 以插入到打印机的一侧为轴，将自动双面组件朝打印机的后部倾斜。旋转自动双面组件两侧的灰色旋钮，将该组件牢固地固定在打印机上。旋转旋钮直到它们处于图中所示的水平位置。

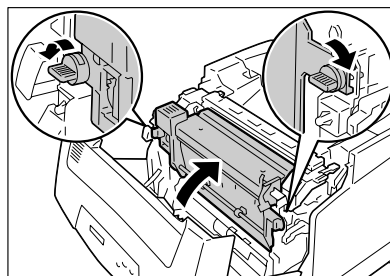

6. 拆下打印机内连接器上的灰色盖子。

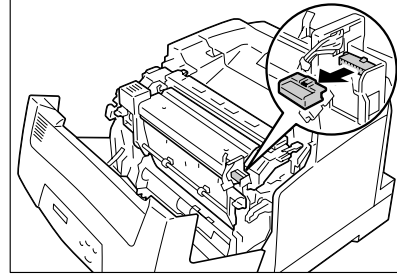

7. 将自动双面组件右侧延伸出的连接器电缆插到打印机的连接器。

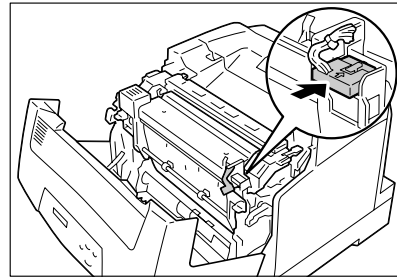

8. 关闭前盖。

重要

- 在关闭前盖时，当心您的手指不要夹在盖板（左侧、右侧、上侧以及下侧边缘处）与打印机之间。

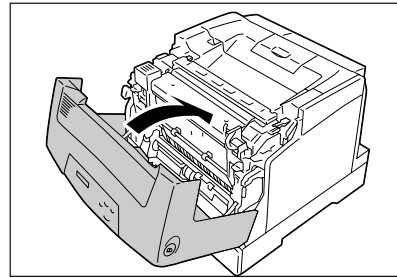

9. 插上电源线并将电源开关按到 <|> 位置，接通电源。

安装完毕。

补充

- 您可以通过打印出 [Printer Settings] 列表来检查自动双面组件是否安装正确。有关如何打印 [Printer Settings] 列表的详情，请参照《快速参考说明书》。
- 安装了自动双面组件之后，请在打印机驱动程序上更改其配置。有关更多详情，请参照打印机驱动程序的在线帮助。

English

한국어

繁體中文

简体中文

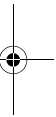
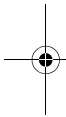
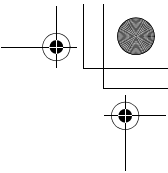
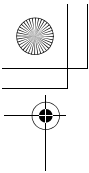

Fuji Xerox Printing Systems Co., Ltd. 604E 23590/DE3590Z4-1 (Edition 1)
November 2006
Copyright© 2006 by Fuji Xerox Co., Ltd.

